

<p>LEGEND</p> <p>Direction of Travel</p> <p>Sign</p> <p>North Arrow</p> <p>Tubular marker</p> <p>Certified TCP</p> <p>HLWD</p>	<p>Figure # 7.8 in the TCMWR 2015 Edition Single Lane Alternating</p> <p>This Traffic Control Plan is designed to accommodate Sidewalk, Curb & Gutter as well as installation of Hydro/Tel and Cable.</p> <p>Work to commence Tuesday, May 21st, 2019 and is expected to be completed in one month</p> <p>Work hours shall be from 7:00 am - 5:00 pm</p> <p>All signs and traffic devices shall be placed in compliance with WCB and the TCMWR</p>	<p>30F RIGHT OF FLAGGING</p> <p>ELEMENT EXCAVATING LTD</p> <p>Drawing No. EE-Coote St-01</p>
---	--	--

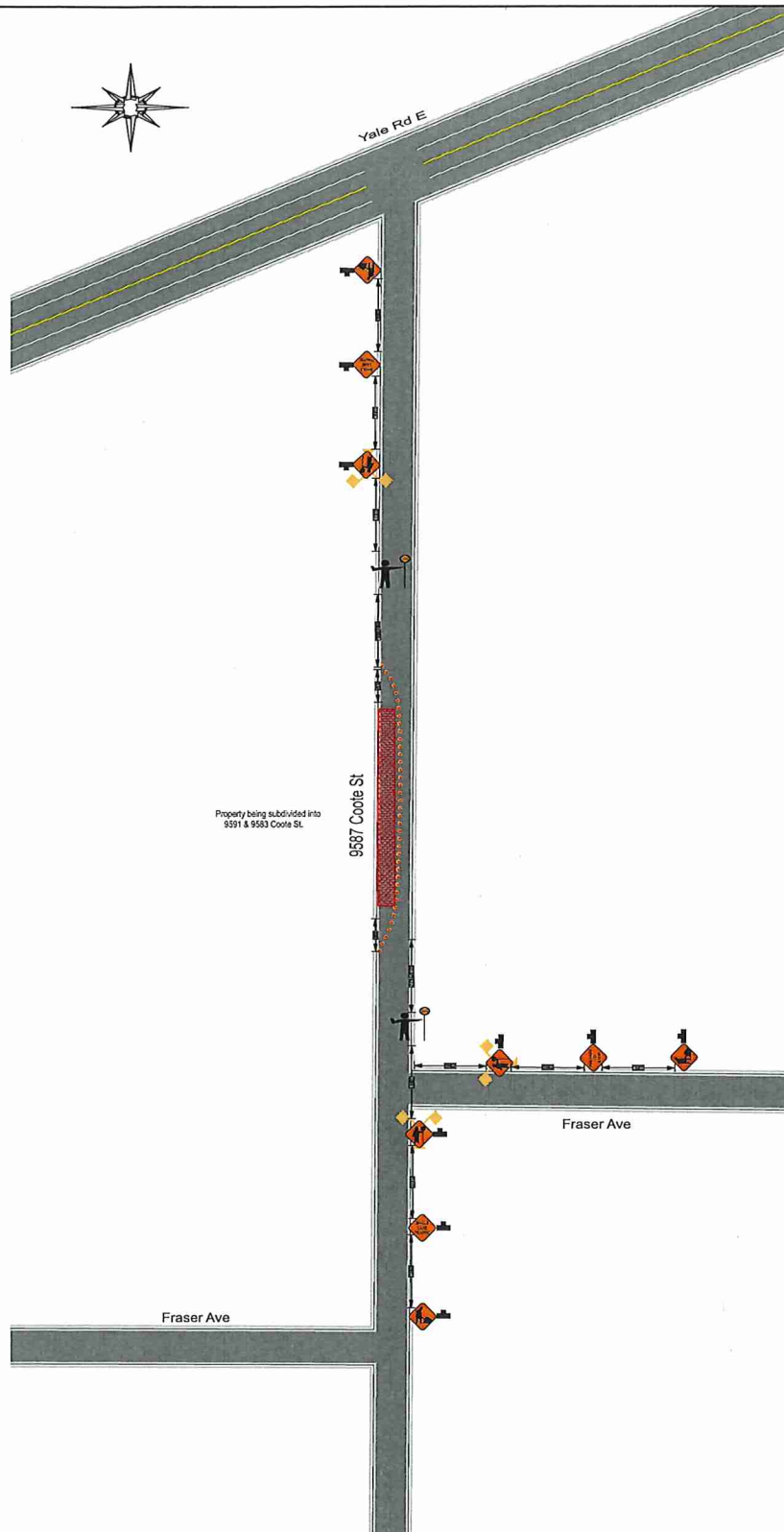

<p>LEGEND</p> <p>— Direction of Travel</p> <p>▲ Sign</p> <p>▲ North Arrow</p> <p> Tubular marker</p> <p>▲ Certified TCP</p> <p>▲ HLWD</p>	<p>Figure # 7.8 in the TCMWR 2015 Edition Single Lane Alternating</p> <p>This Traffic Control Plan is designed to accommodate Sidewalk, Curb & Gutter as well as installation of Hydro/Tel and Cable.</p> <p>Work to commence Tuesday, May 21st, 2019 and is expected to be completed in one month</p> <p>Work hours shall be from 7:00 am - 5:00 pm</p> <p>All signs and traffic devices shall be placed in compliance with WCB and the TCMWR</p>	<p>3 of RIGHT ON FLAGGING</p> <p>ELEMENT EXCAVATING LTD</p> <p>Drawing NTS Drawing No. EE-Coote St-02</p>
---	--	---